

MOGAMBO

words: Danielle Aragon Cabrera

photography: Bruce Thomas



WITH A HINT OF AFRICA, MASCULINE DÉCOR AND A BIG TOY BOX, NOBISKRUG'S 73.5 METRE PROMISES A FUN-FILLED CHARTER, AS WELL AS ALL THE LUXURY YOU EXPECT



MOGAMBO

Mogambo is an African word that means 'the greatest', and is also the name of a 1953 film starring Clark Gable, Ava Gardner and Grace Kelly, conjuring thoughts of remote African outposts and 1950s glamour. For the latest yacht delivered by Nobiskrug, the word 'mogambo' with all these associations is the thread that binds everything together, the feel, the design, even the energy that flows through the yacht, as an understated African symphony of materials woven together by Reymond Langton Design of the UK.

Once the team had the name, Andrew Langton explains, 'the Mogambo theme had to work within a very sleek, contemporary architecture'. Its first concept incorporated golden oak, limestone and natural patterns such as crocodile and snake embossed leathers as well as woven African shields. 'It was regarded as too ethnic, therefore we pared back and went in a more sophisticated, modern direction,' he continues.

Based on the same design philosophy as *Triple Seven*, *Siren*, *Sapphire* and the soon-to-be launched project *Graffiti*, *Mogambo* has smoother lines than the other four custom builds. Also penned by Reymond Langton Design, the exterior look is sleek and strong, slightly masculine, with a two-tone colour scheme of medium grey and snow white. A grey stripe extends from the hull up to the sundeck superstructure, drawing the eyes gradually from the main deck up to the winged mast overhang above, which extends out and slightly flares at the tips. 'We wanted to create an instantly recognisable, very sleek and sporty aesthetic, almost aggressive and strongly influenced by another passion, automotive design. Think Audi R8 sports car. We have designed many high-volume yachts and relished the opportunity to design a sleeker, lower volume yacht,' says Langton.

From the bathing platform, sweeping stairs lead up to the aft main deck and an outdoor lounge partially covered by the overhanging deck above and a removable sun awning. This expansive area incorporates four large sofas, an aft sunbathing area and one of three dining tables aboard. 'The vessel was designed to meet the owner's requirements and specifically to enter the charter market. The outside areas are the best I have seen for that purpose,' says Captain Phil Walsh, a 20-plus-year charter yacht veteran.



'Mogambo is the thread that binds everything together, the feel, the design, even the energy that flows through the yacht as an understated African symphony of materials'

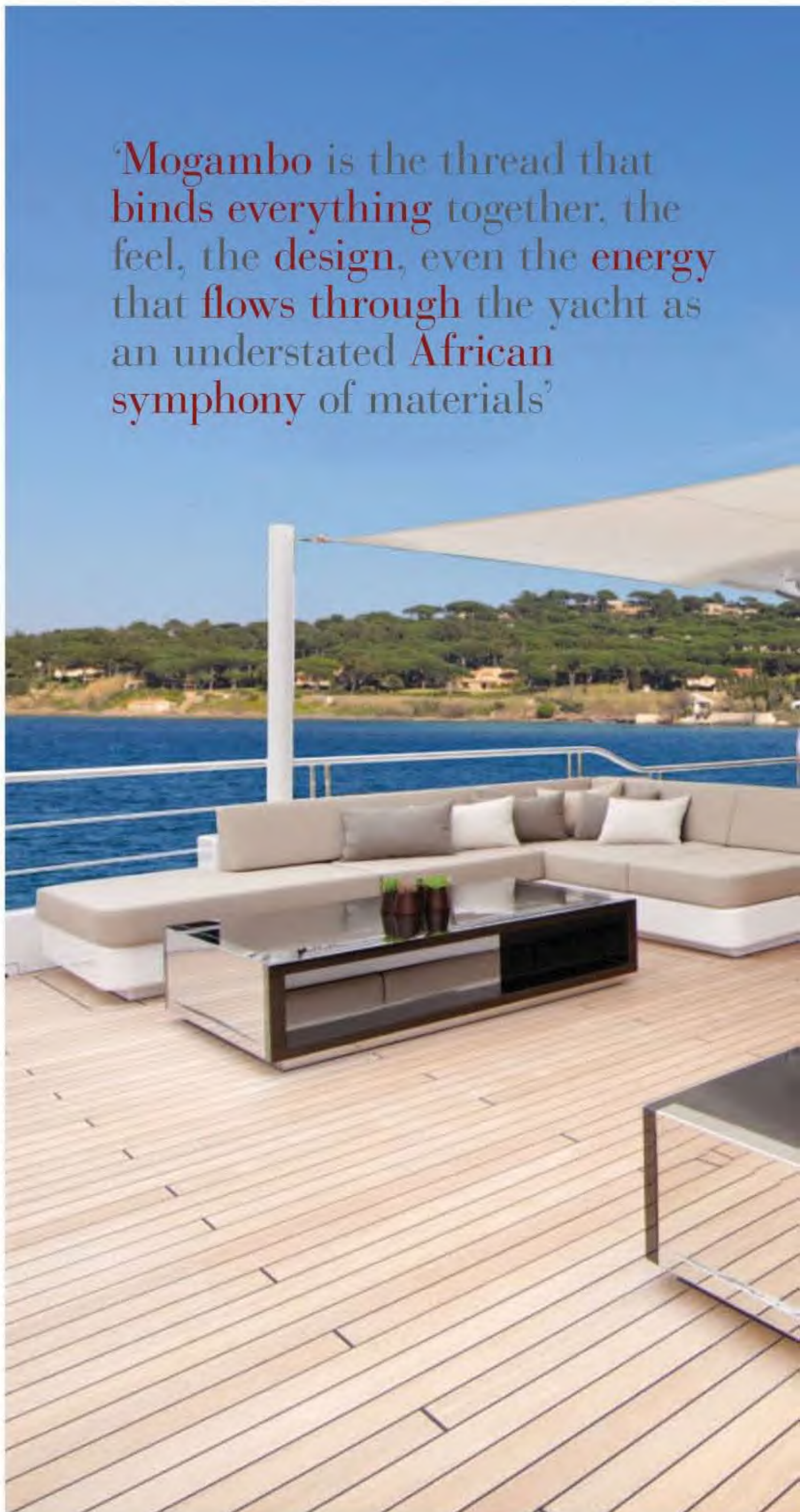





The focal point of the main saloon is the back wall and the backlit triptych artwork by DKT in London. The sandblasted and acid-etched glass is highlighted by copper leaf and metallic highlights, and resembles desert sand dunes. The piece is the largest concentration of colour in the spacious three-sectioned room and the etched colours are the basis for the silk upholstered saloon furniture and cushions. The seating here is split on the centreline and the layout of the Metrica-built furniture mirrors each other.

The relatively low bulwarks aft on the main deck allow for large floor-to-ceiling windows in the main saloon, which stream light into the room, while white

ceilings and strategically placed strips of recessed lights keep the ebonised American walnut on the floors and the dark sycamore walls from darkening the room. 'We eliminated as many downlights as possible by using high-powered LED cove lighting, which reflects the light from the matte white ceilings; we really think they make a bold statement,' says Langton. The same cove lighting is found throughout, including strategic areas in the master suite.

What stands *Mogambo* apart from the rest is the attention to detail of each furniture piece, such as the custom-made ebonised walnut bar with its recessed carved panel at the front; the metal details of the bar

**The relaxed, outdoor
ambiance is perfectly
illustrated by *Mogambo's*
expansive covered lounge,
aft on the main deck
(above), as well as the
sunbathing area and spa
pool on the sundeck
(opposite top)**



‘The vessel was **designed** to meet the **owner’s requirements** and specifically to enter the **charter market**. The **outside areas** are the **best I have seen** for that purpose’







‘What stands *Mogambo* apart is the attention to **detail**, such as the custom **ebonised walnut bar**, the metal details of the bar and the **bronzed** bar stool legs’



and the bar stool legs were bronzed to match all the door hardware aboard. The carved panelling makes appearances throughout the vessel, often enhanced with a metal flower-printed plate. On the bar, the carved panel hides a glassware cabinet.

The dining table, another point of conversation, is veneered in taupe rippled sycamore with a dimmable light box that rises from the tabletop and runs almost its entire length. The dining chairs, like most of the seating furniture aboard, were designed by Raymond Langton.

'There was a huge amount of time spent developing the furniture designs. The pieces have organic shapes, soft curves and interesting textures which contrast the straight and sleek architecture of the rooms,' says Langton. Favourites of the designers, the chairs are lacquered to match the rippled sycamore of the table, while the back of the backrest has a six-tone fur inlay. 'Our first design had a full wooden back, but a chair that size looks too heavy with a wooden back – fur was a fun idea,' Langton continues.

Forward on the main deck, the master is accessed



The table in the main dining area (above) is a dramatic centerpiece, veneered in rippled sycamore and featuring a raised light box along its length. In the beach club seating area (top right) guests can wait for spa treatment or tenders and toys to launch. The many amenities also include the hair salon (middle) and cinema (right)

‘There was a huge amount of time spent developing the furniture designs. The furniture pieces have organic shapes, soft curves and interesting textures’





through a set of custom carved panelled doors with the same metal flower-printed doorplate found in the main saloon. The suite incorporates a study with a desk that looks towards the starboard side, where a large portion of the wall from floor to ceiling hinges down and outwards at the press of a button, to create a balcony. The study can also double as an additional bedroom when a bed folds out from a hidden compartment in the opposing wall.

Forward of the study, another set of doors opens on to the expansive master bedroom with en suite, which fully takes advantage of the full beam forward. The furnishings are sparse for the amount of available space, but looking closely, specific design elements found throughout *Mogambo* all come together in the master in a very subtle manner to achieve the ultimate statement of the design. Each piece has been designed to fit the space exactly; the carpet has a Pertino pattern mimicked in the embroidered cushions as well as on the wall panel that hides the TV. There is also a very subtle hatch pattern on doors and walls that continues the African theme and a piece of petrified wood from Bali that surely adds another tonne of weight to the total. 'It takes multiple crew members to move it when cleaning,' confirms Captain Walsh. Four wardrobes accommodate both the owners' needs and those of charter guests.

To further meet the needs of chartering, the guest cabins are versatile. The VIP on the bridge deck can be converted into a twin cabin, while two of the four double cabins below also convert into twins. Each is delicately appointed in creamy shades of taupe while cushions add hints of the colours found in the specially commissioned paintings.

In the competitive world of chartering, the yacht with the most amenities wins, and *Mogambo* might just hold





'Mogambo ticks so many amenities boxes, including a cinema room that offers day-bed seating, surround sound and a professional screen'



the title with its assortment of capabilities and features.

According to Captain Walsh, 'The swim platform incorporating the beach club, spa, sauna and beauty salon works really well and is most popular with the guests. As are the tenders, jet ski and toy areas.'

The lower deck spa area makes good use of the available space and has access to the tender garage. The seating area can serve as a waiting room for spa treatments, toy usage or when waiting for the tenders to be deployed.

Up on the bridge deck, *Mogambo* keeps ticking the amenities boxes with a cinema room that offers day-bed seating, surround sound and a professional screen. Continuing aft, the upper saloon contrasts the darker main saloon with taupe furnishings and sycamore walls. The room follows the look of the suites with two glass sculptures by Crystal Caviar calling for attention.

Up above, the sundeck has been divided into three areas. Aft of the mast, shaded with sturdy canvas awnings are sunpads and a sitting area that surrounds a



Recessed LED rather than downlighting is a theme throughout, seen to great effect in the full-beam master suite (above), its bathroom (opposite bottom) and study (opposite top)

table. The seating area faces the mast whose wall serves as a screen for an alfresco cinema. Forward is the spa pool, more sunpads and – offering the best views – an air-conditioned gym enclosed by floor to ceiling windows, surely hoping to convince a guest to work out during their holiday.

As for performance, Captain Walsh has nothing but good things to say: 'It is very comfortable at sea and quite fast, able to fast cruise at 16 knots if needed, and like always, the engineering is typical German – first

class. She's a good looking vessel, and the exterior finish is superb.'

Given *carte blanche* with both exterior and interior styling, Reymond Langton has produced an interior that gives a unique taste of Africa. It is enchanting in its simplicity, but given the time – or a rainy afternoon on charter – one could spend hours walking *Mogambo's* four decks and finding elements at first unseen, while taking full advantage of the yacht's copious guest amenities.

MOGAMBO



The sundeck overhang plus an awning create a shelter for an outdoor lounge on the deck below

A matte painted mast wall can become a projection screen to show films at night

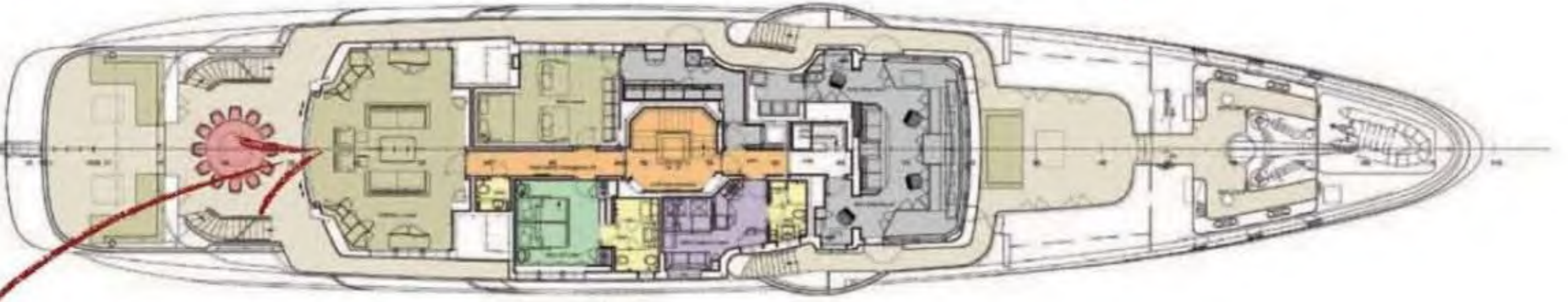

The bridge deck is informal, with a cinema, the upper saloon further aft and an exterior dining area to stern, one of three dining tables on board

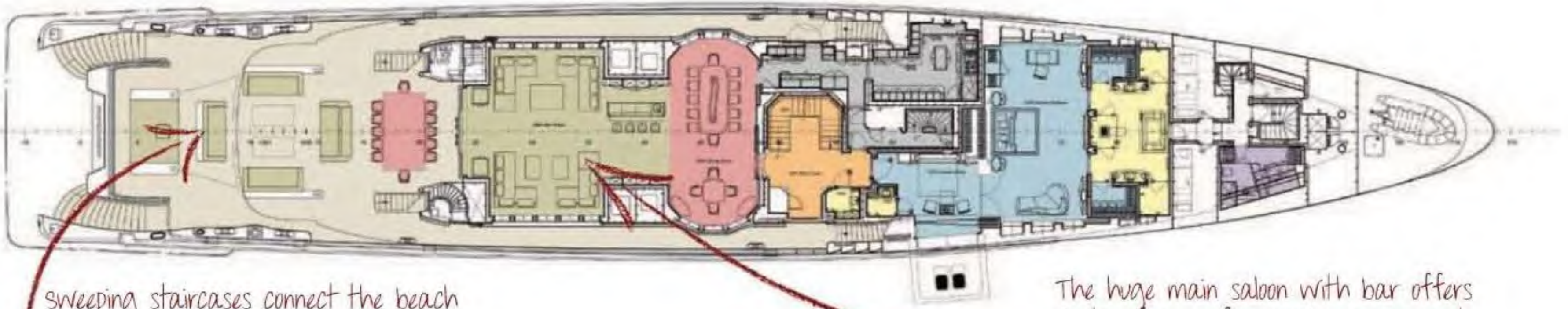

Sweeping staircases connect the beach club and main deck, where a lounge and yet another dining area await

The huge main saloon with bar offers plenty of room for socialising. Forward is the owner's suite, also impressively sized, with study and balcony



Fitting between the two tenders, the lower deck beach club leads out to the stern swim platform

Surrounding the central staircase are four en suite guest cabins, two of which convert to twins

MOGAMBO Nobiskrug

LOA 73.51m
LWL 58.7m
Beam 12.6m
Draught 3.65m
Displacement 1,590T
Gross tonnage 1,682GT

Engines
 2 x MTU 16V, 4000 M60 at 1,760kW
Speed (max/cruise)
 17.3/14 knots
Range at 14 knots
 5,000nm
Bowthruster Schottel

Generators
 3 x Man/Stamford
Fuel capacity
 184,000 litres
Water capacity
 37,700 litres
Owner and guests 12
Crew 12-18

Tenders
 1 x 11.6m Novurania Chase 38; 1 x 7.5m Novurania Launch 750
Construction Steel/GRP
Classification
 Germanischer Lloyd
Naval architecture
 Nobiskrug

Interior and exterior design
 Reymond Langton Design
Owner's project manager
 Hill Robinson
Charter details
 From €550,000 per week, plus expenses
 Hill Robinson

tel: +33 4 92 90 59 59
 email: info@hillrobinson.com
 web: hillrobinson.com
Builder/year
 Nobiskrug/2012
 Rendsburg, Germany
 tel: +49 4331 207 180
 web: nobiskrug.com